

SIERRA WAY

SEPULVEDA AVE.



TYPICAL  
RELOCATION  
DETAILS  
TREE, SHRUB, AND SPRINKLER  
BLOCK WALL REMOVAL AND REPAIR

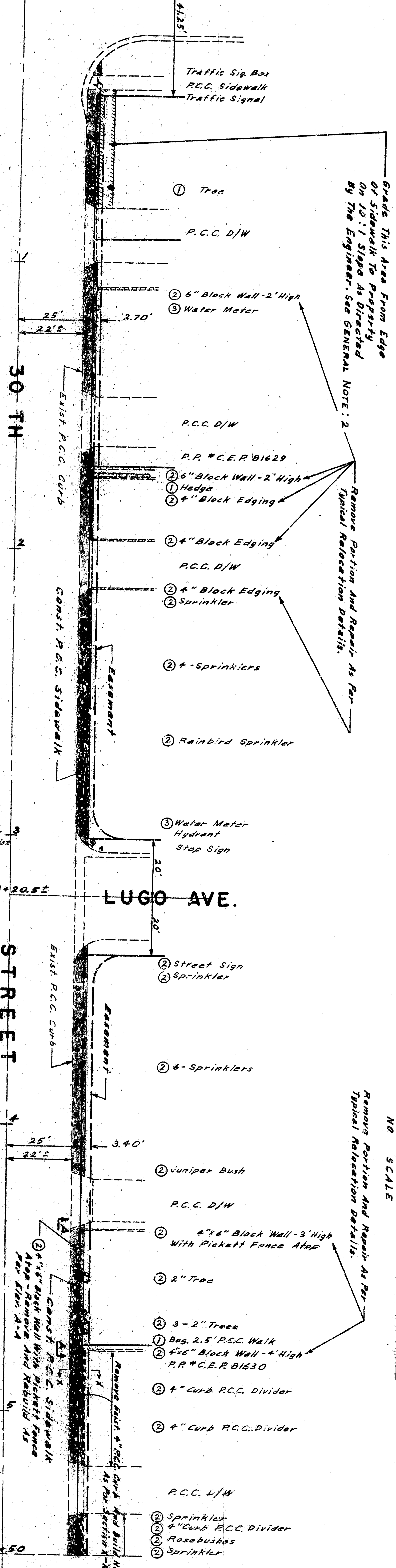
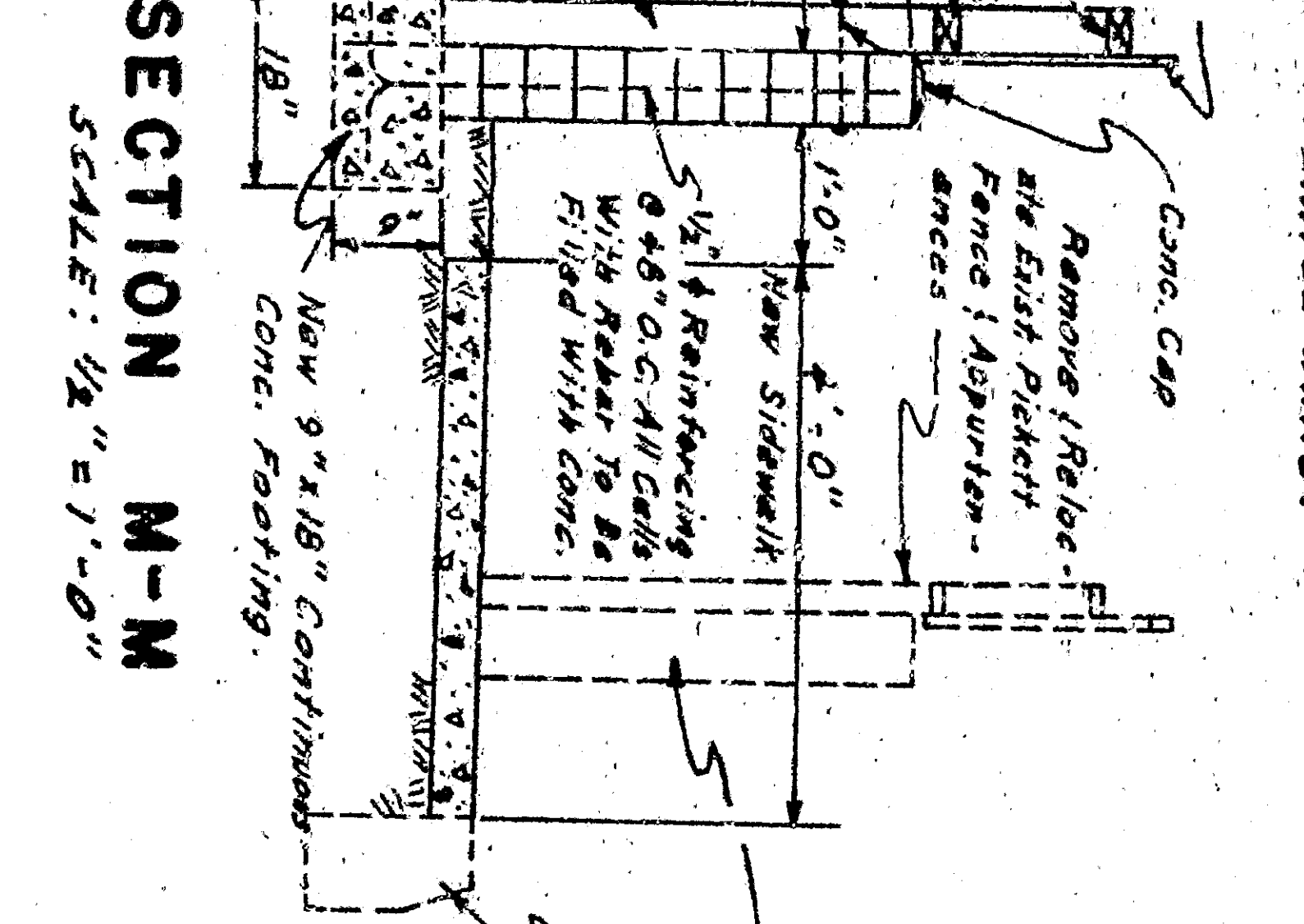
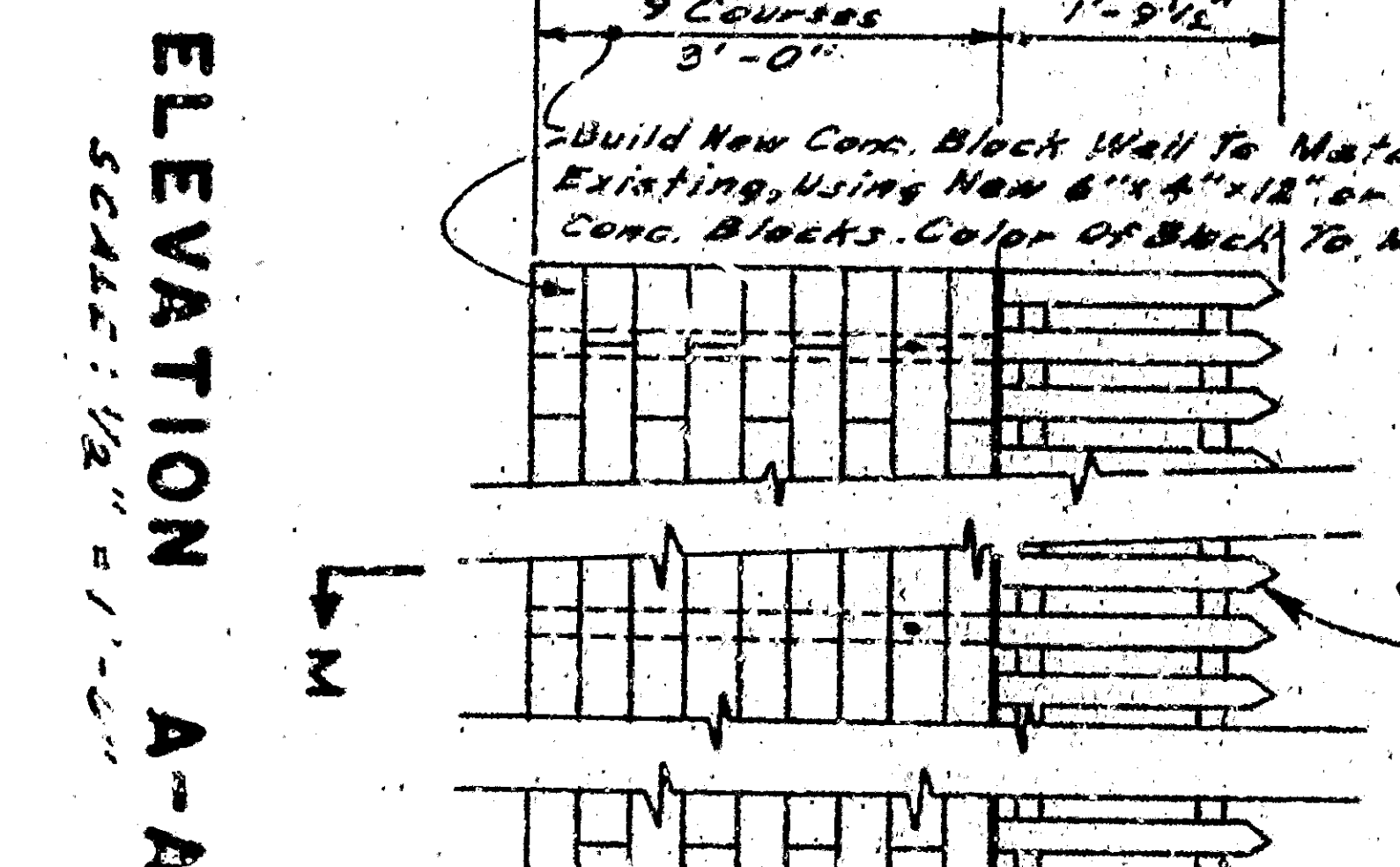
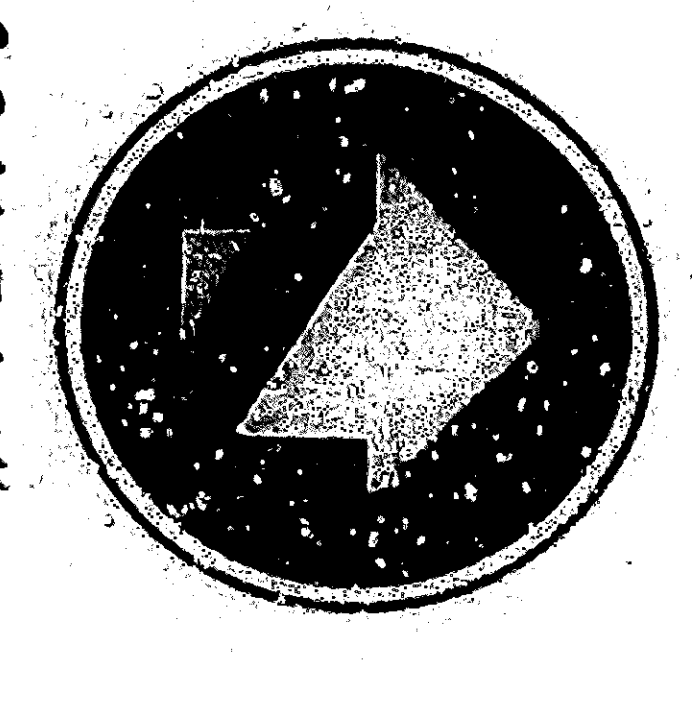
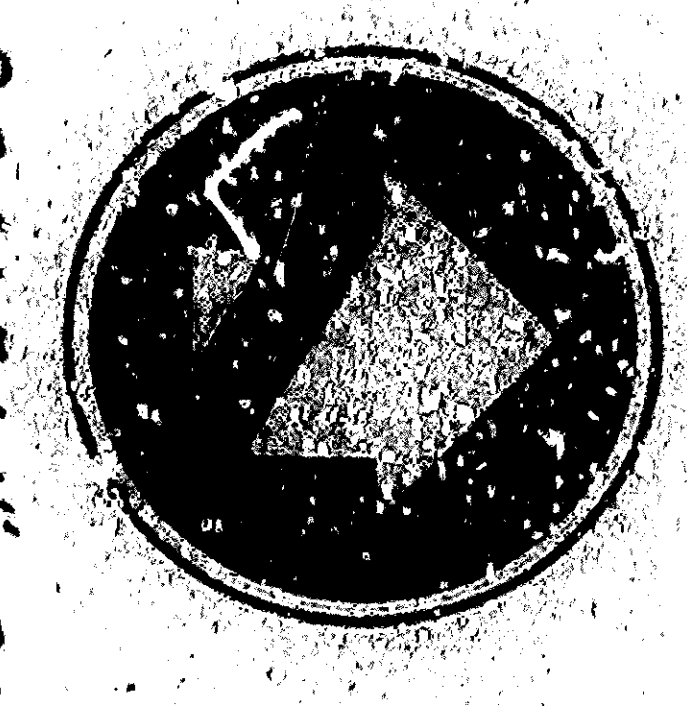
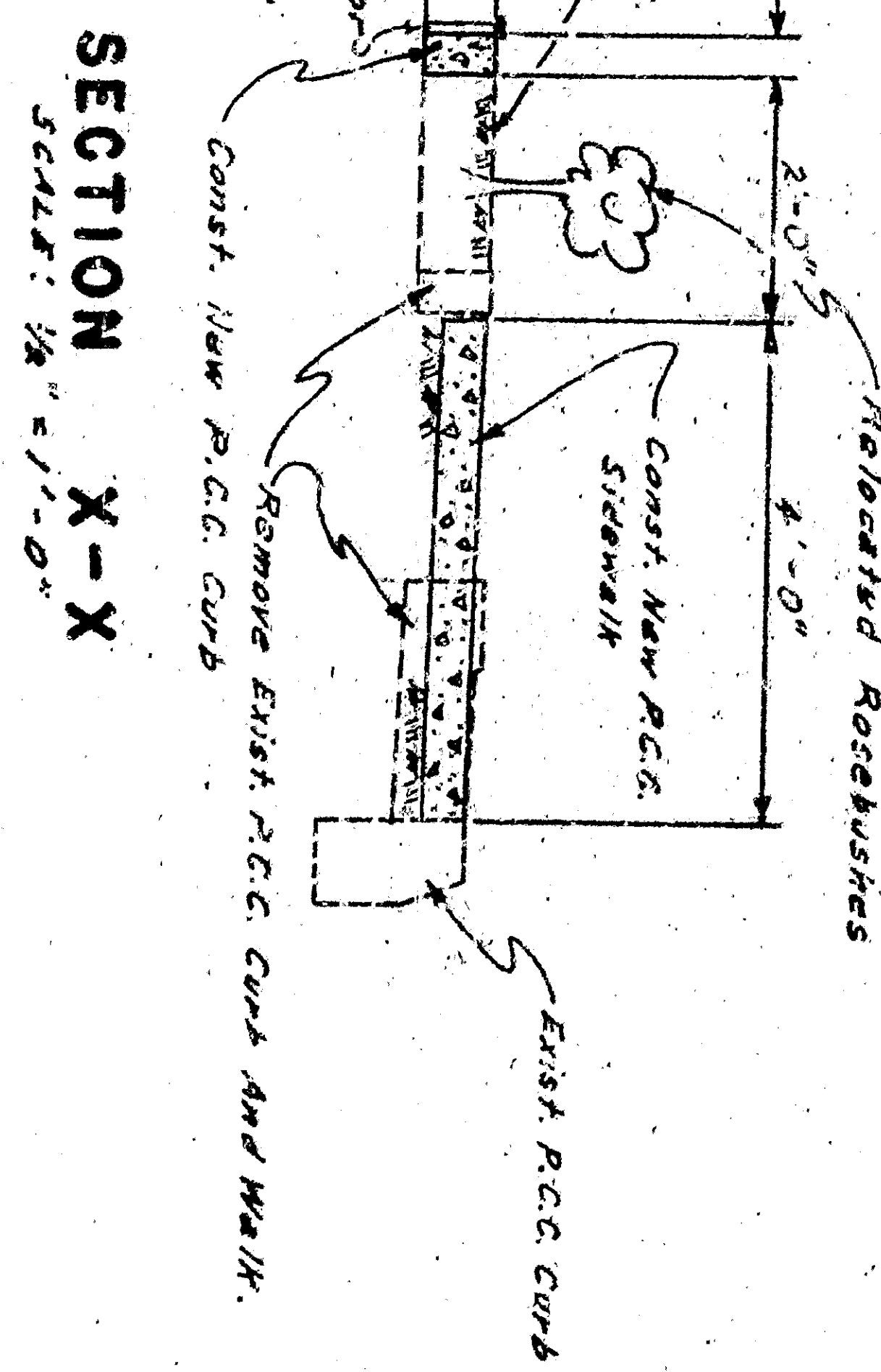
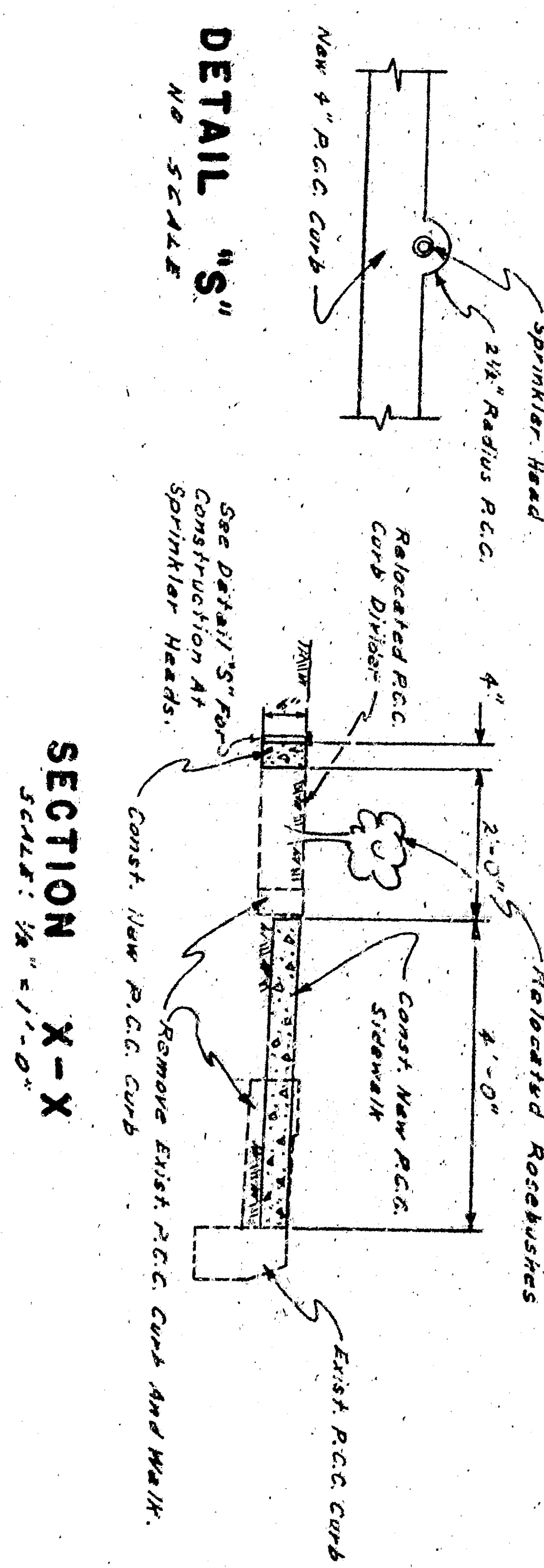

APPROVED	DATE	NO.	REVISION
CITY ENGINEER	7-27-77	1	REVISION NO. 1 DELETED
REGISTERED CIVIL ENGINEER NO. 45854		2	DELETE SIDEWALK STATION 10+24 TO 10+24.5
DRAWN BY: <i>W. J. ...</i>			
CHECKED BY: <i>W. J. ...</i>			
RECORDED BY: <i>W. J. ...</i>			
CITY OF SAN BERNARDINO			
DEPARTMENT OF ENGINEERING			
NORTH SIDE OF 30 <sup>TH</sup> STREET			
SIERRA WAY TO WATERMAN AVE.			
SIDEWALK			